



FEATURING NEW HOMES

OFFICIAL LAUNCH

UPCOMING PROJECTS

New Development at Bukit Timah Link



The upcoming development at Bukit Timah Link will be designed by the President's Design Award winner, Khoo Peng Beng and Belinda Huang of Arc Studio Architecture + Urbanism Pte Ltd. The residential development is located at the heart of the vibrant Beauty World precinct, a gentrifying urban village framed by the lush foothills of Bukit Timah, the bygone industrial factories of the early 20th century, the former Malayan Railway, and the residential Good Class Bungalow enclave at King Albert Park.

The exclusive development's strategic location is a mere 2-minute walk from Beauty World MRT Station, offering quick access to the Central Business District and Marina Bay Sands. At the centre of the Beauty World neighbourhood, amenities and malls are within easy reach.

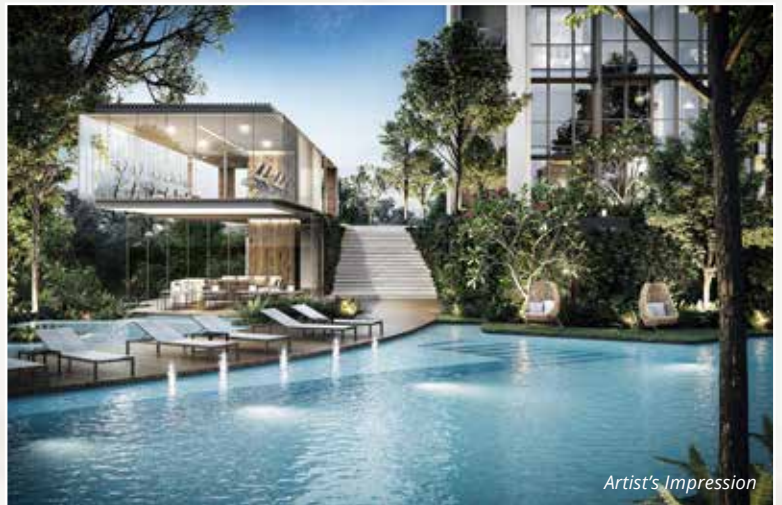

Residents can also embrace the great outdoors, with the development's proximity to an abundance of recreation options including Bukit Timah Nature Reserve, Rifle Range Nature Park and The Rail Corridor, and enjoy the convenience of planning for their children's education at Bukit Timah Link. Additionally, it is located within 1-kilometre* radius of Pei Hwa Presbyterian Primary School and conveniently accessible to renowned schools along Bukit Timah Road.

A holistic range of facilities are available, catering to residents of all ages. With a selection of 1 to 4 bedroom layouts thoughtfully designed to meet different lifestyle needs, the development seeks to create a future vision for a flexible and sustainable lifestyle, blending cosmopolitan vibes with its tropical industrial heritage.

- **District 21**
- **Upper Bukit Timah**
- **99-Year Leasehold**
- **155 Residences**

All distances and travelling times are approximates only. * Source: onemap.gov.sg



ENQUIRY

86663339